

# rtc<sup>®</sup>

COUPLING TECHNOLOGY

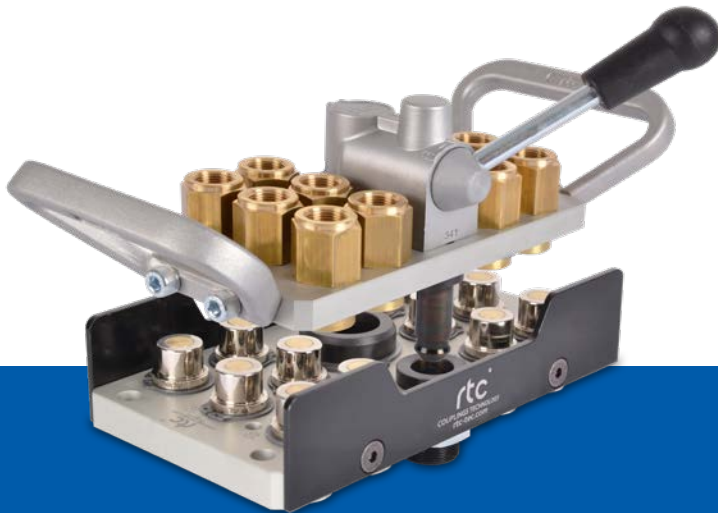

[www.rtc-tec.com](http://www.rtc-tec.com)  
[www.rtc-couplings.com](http://www.rtc-couplings.com)



EUROPEAN Type - EUROPÄISCHER Typ - AVRUPA Tip

Temperature Range - Temperaturbereich  
-10°C +180°C (+14°F +356°F) FPM (V)

Max.Working Pressure - Max.Betriebsdruck  
16 bar (232 PSI)

Flow size - Nennweiten

rtc 090.06 6 mm  
rtc 090.09 9 mm  
rtc 090.13 13 mm

Standard version - Standardversion

Brass - Messing  
FPM (V) PTFE coated - Viton PTFE beschichtet  
With Valve - mit Ventil  
Sleeve - Nickel Plate

Option - Optionen - Seçenek

Safety lock - Sicherheitsverriegelung - Emniyetli Kapak

Safety Type

TYPE 090 **rtc**



**WATER**

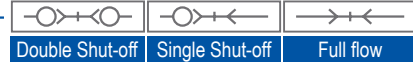

**rtc** TYPE 100

Safety Type



FRENCH Type - FRANZÖSISCHER Typ - FRANSIZ Tip

Temperature Range - Temperaturbereich - Sıcaklık Aralığı  
-20°C +100°C (-4°F +212°F) Nitril (N)  
-10°C +180°C (+14°F +356°F) FPM (V)

Max.Working Pressure - Max. Betriebsdruck - Max. Çalışma Basıncı  
10 bar (145 PSI)

Flow size - Nennweiten - Akış Çapı

rtc 100.06 6 mm  
rtc 100.08 8 mm  
rtc 100.12 13 mm

SAFETY Type -  
Typ SICHERHEITSVERRIEGELUNG  
EMNİYETLİ Tip

Flow size - Nennweiten - Akış Çapı

rtc 100.06-S\* 6 mm  
rtc 100.08-S\* 8 mm  
rtc 100.12-S\* 13 mm



SAFETY TYPE  
FOR DISCONNECT  
PROTECTION



**WATER**

Temperature Range - Temperaturbereich - Sıcaklık Aralığı

-20°C +100°C (-4°F +212°F) Nitril (N)  
-10°C +180°C (+14°F +356°F) FPM (V)

Max.Working Pressure - Max. Betriebsdruck - Max. Çalışma Basıncı  
16 bar (232 PSI)

Flow size - Nennweiten - Akış Çapı

rtc 101.06 6 mm  
rtc 101.09 9 mm  
rtc 101.10\* 10 mm  
rtc 101.12 12 mm  
rtc 101.16 16 mm  
rtc 101.20 20 mm  
rtc 101.25 25 mm  
rtc 101.38 38 mm

TYPE 101 **rtc**

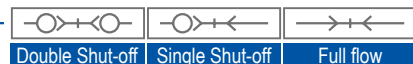

**rtc** TYPE 099

Safety Type



INTERNATIONAL Type - INTERNATIONAL Typ - ULUSLARARASI Tip

Temperature Range - Temperaturbereich - Sıcaklık Aralığı  
-10°C +180°C (+14°F +356°F) FPM (V)

Max.Working Pressure - Max. Betriebsdruck - Max. Çalışma Basıncı  
16 bar (232 PSI)

Flow size - Nennweiten - Akış Çapı

rtc 099.06	6 mm
rtc 099.09	9 mm
rtc 099.15	15 mm

Standard version - Standardversion - Standart Versiyon

Brass - Messing - Pirinç  
Seals FPM (V) - FPM dichtungten - FPM Conta

Option - Optionen - Seçenek

Safety lock - Sicherheitsentriegelung - Emniyetli Kapak



Temperature Range - Temperaturbereich - Sıcaklık Aralığı  
-20°C +100°C (-4°F +212°F) Nitril (N)  
-10°C +180°C (+14°F +356°F) FPM (V)

Working Pressure - Betriebsdruck - Çalışma Basıncı  
Brass/Messing: 50-210 bar (725 - 3045 PSI)  
Stainless Steel/Edensthal: 100-300 bar (1450-4350 PSI)

Flow size - Nennweiten - Akış Çapı

rtc 070.04	4 mm
rtc 070.08	8 mm
rtc 070.10	10 mm
rtc 070.13	13 mm
rtc 070.16	16 mm
rtc 070.19	19 mm
rtc 070.32	32 mm
rtc 070.38	38 mm
rtc 070.50	50 mm

ISO 7241-1 SERIE B

TYPE 070 **rtc**



Flat Faced Non-Spill - Flachdichtende Ausführung  
Düz Alınlı Damlatmasız

Temperature Range - Temperaturbereich - Sıcaklık Aralığı  
-20°C +100°C (-4°F +212°F) Nitril (N)  
-10°C +180°C (+14°F +356°F) FPM (V)

Max.Working Pressure - Max. Betriebsdruck - Max. Çalışma Basıncı  
16-50 bar (232-750 PSI)

Flow size - Nennweiten - Akış Çapı

rtc 152.03	3 mm
rtc 152.06	6 mm
rtc 152.08	8 mm
rtc 152.10	10 mm
rtc 152.12	12 mm
rtc 152.16	16 mm
rtc 152.20	20 mm
rtc 152.25	25 mm
rtc 152.32	32 mm
rtc 152.38	38 mm
rtc 152.50	50 mm

**rtc** TYPE 152

High Flow Rate

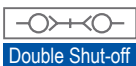

WATER

WATER  
PNEUMATIC  
HYDRAULIC

TYPE 102 **rtc**

One Hand Connection "PUSH-PULL" Disconnection  
Eine Hand Kuppeln "PUSH-PULL" Lösen  
Tek El ile Kapağı "ÇEKEREK-İTEREK" Çıkarma

Temperature Range - Temperaturbereich - Sıcaklık Aralığı  
-20°C +100°C (-4°F +212°F) Nitril (N)  
-10°C +180°C (+14°F +356°F) FPM (V)

Max.Working Pressure - Max. Betriebsdruck - Max. Çalışma Basıncı  
50 bar (725 PSI)

Flow size - Nennweiten - Akış Çapı

<b>rtc</b> 102.03	3 mm
<b>rtc</b> 102.06	6 mm
<b>rtc</b> 102.07	7 mm
<b>rtc</b> 102.09	9 mm
<b>rtc</b> 102.12	12 mm
<b>rtc</b> 102.16	16 mm
<b>rtc</b> 102.25	25 mm



WATER

**rtc** TYPE 093



Temperature Range - Temperaturbereich - Sıcaklık Aralığı  
-20°C +100°C (-4°F +212°F) Nitril (N)  
-10°C +180°C (+14°F +356°F) FPM (V)

Max.Working Pressure - Max. Betriebsdruck - Max. Çalışma Basıncı  
20 bar (290 PSI)

Flow size - Nennweiten - Akış Çapı  
**rtc** 093.08 8 mm



WATER

Single & Double Shut-Off

TYPE 106 **rtc**

Temperature Range - Temperaturbereich - Sıcaklık Aralığı  
-20°C +100°C (-4°F +212°F) Nitril (N)  
-10°C +180°C (+14°F +356°F) FPM (V)



Max.Working Pressure - Max. Betriebsdruck - Max. Çalışma Basıncı  
10 bar (145 PSI)

Flow size - Nennweiten - Akış Çapı

<b>rtc</b> 106.19	19 mm
<b>rtc</b> 106.25	25 mm
<b>rtc</b> 106.33	33 mm
<b>rtc</b> 106.42*	42 mm
<b>rtc</b> 106.50	50 mm
<b>rtc</b> 106.63*	63 mm
<b>rtc</b> 106.110*	110 mm



WATER

**rtc** TYPE 097 & 098

Temperature Range - Temperaturbereich - Sıcaklık Aralığı  
-10°C +180°C (+14°F +356°F) FPM (V)

Max.Working Pressure - Max. Betriebsdruck - Max. Çalışma Basıncı  
100 bar (1450 PSI)

Flow size - Nennweiten - Akış Çapı  
rtc 097.08 8 mm

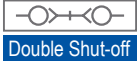

Double Shut-off



Temperature Range - Temperaturbereich - Sıcaklık Aralığı  
-10°C +180°C (+14°F +356°F) FPM (V)

Max.Working Pressure - Max. Betriebsdruck - Max. Çalışma Basıncı  
16 - 20 bar (232 - 290 PSI)

Flow size - Nennweiten - Akış Çapı

rtc 098.06 6 mm  
rtc 098.08 8 mm  
rtc 098.12 12 mm

WATER

Leak Tight on Connection & Disconnection

Temperature Range - Temperaturbereich - Sıcaklık Aralığı  
-20°C +100°C (-4°F +212°F) Nitril (N)  
-10°C +180°C (+14°F +356°F) FPM (V)  
0°C +250°C (+32°F +482°F) FFKM (W)

Max.Working Pressure - Max. Betriebsdruck - Max. Çalışma Basıncı  
16 bar (232 PSI)

Flow size - Nennweiten - Akış Çapı

rtc 105.09 9 mm  
rtc 105.12 12 mm  
rtc 105.16 16 mm  
rtc 105.20 20 mm  
rtc 105.25 25 mm

**TYPE 105** **rtc**

Double Shut-off

WATER

**rtc** TYPE 108

Double Shut-off

One Hand Connection "PUSH-PULL" Disconnection  
Eine Hand Kuppeln "PUSH-PULL" Lösen  
Tek El ile Kapağı "ÇEKEREK-İTEREK" Çıkarma

Temperature Range - Temperaturbereich - Sıcaklık Aralığı  
-20°C +100°C (-4°F +212°F) Nitril (N)  
-10°C +180°C (+14°F +356°F) FPM (V)

Max.Working Pressure - Max. Betriebsdruck - Max. Çalışma Basıncı  
180 bar (2610 PSI)

Flow size - Nennweiten - Akış Çapı

rtc 108.06 6 mm  
rtc 108.07 7 mm  
rtc 108.09 9 mm  
rtc 108.12 12 mm  
rtc 108.16 16 mm

WATER  
HYDRAULIC

New Flow Sizes

Safety Type

TYPE 103 **rtc**

Temperature Range - Temperaturbereich - Sıcaklık Aralığı

-20°C +100°C (-4°F +212°F) Nitril (N)  
-10°C +180°C (+14°F +356°F) FPM (V)

Max. Working Pressure - Max. Betriebsdruck - Max. Çalışma Basıncı

rtc 103.06*	6 mm	800 bar (11.600 PSI)
rtc 103.07*	7 mm	550 bar (8.000 PSI)
rtc 103.08	8 mm	450 bar (6.525 PSI)
rtc 103.11	11 mm	450 bar (6.525 PSI)
rtc 103.12	12 mm	400 bar (5.800 PSI)
rtc 103.15	15 mm	400 bar (5.800 PSI)
rtc 103.19	19 mm	400 bar (5.800 PSI)
rtc 103.25	25 mm	350 bar (5.075 PSI)
rtc 103.33	33 mm	350 bar (5.075 PSI)



Max. Residual Pressure for Connection Under Pressure (150 bar / only 103.07 is 400 bar)

Max. Restruck für die Verbindung unter Druck (150 bar / nur 103.07 ist 400 bar)

Max. Basınç Altında Takma Basıncı (150 bar / sadece 103.07 400 bar)

**HYDRAULIC**

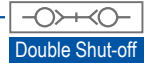

**rtc** TYPE 124



Temperature Range - Temperaturbereich - Sıcaklık Aralığı

-20°C +100°C (-4°F +212°F) Nitril (N)  
-10°C +180°C (+14°F +356°F) FPM (V)

Max. Working Pressure - Max. Betriebsdruck - Max. Çalışma Basıncı

rtc 124.06	450 bar (6525 PSI)
rtc 124.08	450 bar (6525 PSI)
rtc 124.09	350 bar (5075 PSI)
rtc 124.12	350 bar (5075 PSI)
rtc 124.16	350 bar (5075 PSI)

Flow size - Nennweiten - Akış Çapı

rtc 124.06	6 mm
rtc 124.08	8 mm
rtc 124.09	9 mm
rtc 124.12	12 mm
rtc 124.16	16 mm

Max. Residual Pressure for Connection Under Pressure (150 bar)

Max. Restruck für die Verbindung unter Druck (150 bar)

Max. Basınç Altında Takma Basıncı (150 bar)

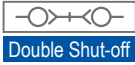

**HYDRAULIC**

ISO 6150 - C

TYPE 170 **rtc**

Temperature Range - Temperaturbereich - Sıcaklık Aralığı

-20°C +100°C (-4°F +212°F) Nitril (N)  
-10°C +180°C (+14°F +356°F) FPM (V)

Flow size - Nennweiten - Akış Çapı

Max. Working Pressure - Max. Betriebsdruck - Max. Çalışma Basıncı

rtc 170.03	3 mm	400 bar (5800 PSI)
rtc 170.06	5.5 mm	450 bar (6525 PSI)
rtc 170.08	8 mm	400 bar (5800 PSI)
rtc 170.11	11 mm	350 bar (5100 PSI)
rtc 170.12	12 mm	350 bar (5100 PSI)
rtc 170.13	13 mm	350 bar (5100 PSI)
rtc 170.16	16 mm	320 bar (4635 PSI)
rtc 170.19	19 mm	300 bar (4350 PSI)



**WATER**  
**PNEUMATIC**  
**HYDRAULIC**

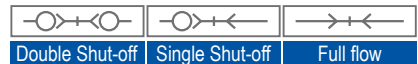

**rtc** TYPE 072 ISO 16028

Safety Type



Temperature Range - Temperaturbereich - Sıcaklık Aralığı  
-20°C +100°C (-4°F +212°F) Nitril (N)  
-10°C +180°C (+14°F +356°F) FPM (V)

Working Pressure - Betriebsdruck - Çalışma Basıncı  
270 - 325 bar (3925 - 4725 PSI)

Flow size - Nennweiten - Akış Çapı

rtc 072.06	6 mm
rtc 072.10	10 mm
rtc 072.12	12 mm
rtc 072.16	16 mm

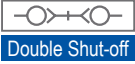

Double Shut-off

**HYDRAULIC**

Temperature Range - Temperaturbereich - Sıcaklık Aralığı

-20°C +100°C (-4°F +212°F) Nitril (N)  
-10°C +180°C (+14°F +356°F) FPM (V)

Max. Working Pressure - Max. Betriebsdruck - Max. Çalışma Basıncı  
500 bar (7250 PSI)

Flow size - Nennweiten - Akış Çapı

rtc 126.08	8 mm
rtc 126.12	12 mm
rtc 126.20	20 mm
rtc 126.25	25 mm
rtc 126.33	33 mm



TYPE 126 **rtc**

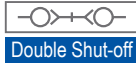

Double Shut-off

**HYDRAULIC**

**rtc** TYPE 104

Temperature Range - Temperaturbereich - Sıcaklık Aralığı

-20°C +100°C (-4°F +212°F) Nitril (N)  
-10°C +180°C (+14°F +356°F) FPM (V)

Working Pressure - Betriebsdruck - Çalışma Basıncı  
16 - 500 bar (230 - 7250 PSI)

Flow size - Nennweiten - Akış Çapı

rtc 104.04	4 mm
rtc 104.06	6 mm
rtc 104.08	8 mm
rtc 104.10	10 mm
rtc 104.12	12 mm
rtc 104.15	15 mm
rtc 104.20	20 mm
rtc 104.25	25 mm
rtc 104.32	32 mm
rtc 104.37	37 mm
rtc 104.50	50 mm
rtc 104.75	75 mm



Double Shut-off

**WATER**  
**PNEUMATIC**  
**HYDRAULIC**

Low Pressure

TYPE 200 **rtc**

Compatible - Kompatibilität - Muadil  
Walther LP Type

Temperature Range - Temperaturbereich - Sıcaklık Aralığı  
-20°C +100°C (-4°F +212°F) Nitril (N)  
-10°C +180°C (+14°F +356°F) FPM (V)

Working Pressure - Betriebsdruck - Çalışma Basıncı  
30 - 100 bar (435 - 1450 PSI)

Flow size - Nennweiten - Akış Çapı

rtc 200.04	4 mm
rtc 200.06	6 mm
rtc 200.07	7 mm
rtc 200.09	9 mm
rtc 200.12	12 mm
rtc 200.19	19 mm
rtc 200.32	32 mm
rtc 200.50	50 mm



WATER  
PNEUMATIC  
HYDRAULIC

**rtc** TYPE 201

Medium Pressure



Compatible - Kompatibilität - Muadil  
Walther MD Type

Temperature Range - Temperaturbereich - Sıcaklık Aralığı  
-20°C +100°C (-4°F +212°F) Nitril (N)  
-10°C +180°C (+14°F +356°F) FPM (V)

Working Pressure - Betriebsdruck - Çalışma Basıncı  
100 - 250 bar (1450 - 3625 PSI)

Flow size - Nennweiten - Akış Çapı

rtc 201.06	6 mm
rtc 201.07	7 mm
rtc 201.12	12 mm
rtc 201.19	19 mm
rtc 201.25	25 mm
rtc 201.32	32 mm
rtc 201.50	50 mm



HYDRAULIC

High Pressure

TYPE 202 **rtc**

Compatible - Kompatibilität - Muadil  
Walther HP Type

Temperature Range - Temperaturbereich - Sıcaklık Aralığı  
-20°C +100°C (-4°F +212°F) Nitril (N)  
-10°C +180°C (+14°F +356°F) FPM (V)

Working Pressure - Betriebsdruck - Çalışma Basıncı  
200 - 2000 bar (2900 - 29000 PSI)

Flow size - Nennweiten - Akış Çapı

rtc 202.04	4 mm
rtc 202.06	6 mm
rtc 202.10	10 mm
rtc 202.16	16 mm
rtc 202.20	20 mm
rtc 202.32	32 mm
rtc 202.50	50 mm

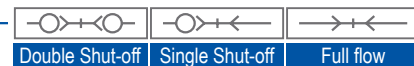

HYDRAULIC



**rtc** TYPE 203

High Temperature



Compatible - Kompatibilität - Muadil  
Walther TE Type

Temperature Range - Temperaturbereich - Sıcaklık Aralığı  
-20°C +270°C (-4°F +518°F) PTFE (T)

Working Pressure - Betriebsdruck - Çalışma Basıncı  
30 - 100 bar (435 - 1450 PSI)

Flow size - Nennweiten - Akış Çapı

<b>rtc</b> 203.09	9 mm
<b>rtc</b> 203.12	12 mm
<b>rtc</b> 203.19	19 mm
<b>rtc</b> 203.32	32 mm
<b>rtc</b> 203.50	50 mm



Double Shut-off | Single Shut-off | Full flow

**HYDRAULIC**

Compatible - Kompatibilität - Muadil  
Walther UF Type

Temperature Range - Temperaturbereich - Sıcaklık Aralığı  
-20°C +100°C (-4°F +212°F) Nitril (N)  
-10°C +180°C (+14°F +356°F) FPM (V)

Working Pressure - Betriebsdruck - Çalışma Basıncı  
40 - 30 bar (580 - 435) for liquids  
30 - 10 bar (435 - 145) for gases

Flow size - Nennweiten - Akış Çapı

<b>rtc</b> 204.06	6 mm
<b>rtc</b> 204.07	7 mm
<b>rtc</b> 204.12	12 mm
<b>rtc</b> 204.19	19 mm
<b>rtc</b> 204.32	32 mm

Available Codes - Verfügbaren Codes



Coded Un-Interchangeable serie

TYPE 204 **rtc**



Double Shut-off | Single Shut-off | Full flow

**WATER**  
**PNEUMATIC**  
**HYDRAULIC**

**rtc** TYPE 205



Compatible - Kompatibilität - Muadil  
Walther CT Type

Temperature Range - Temperaturbereich - Sıcaklık Aralığı  
-10°C +180°C (+14°F +356°F) FPM (V)  
-20°C +150°C (-4°F +302°F) EPDM (E)  
0°C +250°C (-40°F +482°F) FFKM (W)

Working Pressure - Betriebsdruck - Çalışma Basıncı  
40 - 65 bar (580 - 930)

Flow size - Nennweiten - Akış Çapı

<b>rtc</b> type 205.05	5 mm
<b>rtc</b> type 205.07	7 mm
<b>rtc</b> type 205.09	9 mm
<b>rtc</b> type 205.12	12 mm
<b>rtc</b> type 205.19	19 mm



Double Shut-off | Single Shut-off | Full flow

**HYDRAULIC**

Compatible - Kompatibilität - Muadil  
Cejn 115

Temperature Range - Temperaturbereich - Sıcaklık Aralığı  
-20°C +100°C (-4°F +212°F) Nitril (N)

Max.Working Pressure - Max. Betriebsdruck - Max. Çalışma Basıncı  
1.000 bar (100 MPa - 14,503PSI)

Flow size - Nennweite  
rtc 080.04 4 mm

**Technical Specifications & Advantages**

- Ultimate High Pressure (UHP) dripless hydraulic coupling.
- Plug and Coupler has plastic dust cap in order to increase the service life.
- Dripless connection and disconnection
- Aluminium Dust cap is also available.
- Uninterchangeable sister coupling is also available in order to avoid any mis-connection. (rtc 082.04)

Ultimate High Pressure (UHP)

TYPE 080 **rtc**

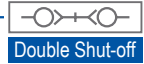

**HYDRAULIC**

**rtc** TYPE 081

Ultimate High Pressure (UHP)



Compatible - Kompatibilität - Muadil  
Cejn 116

Temperature Range - Temperaturbereich - Sıcaklık Aralığı  
-20°C +100°C (-4°F +212°F) Nitril (N)

Max.Working Pressure - Max. Betriebsdruck - Max. Çalışma Basıncı  
1.500 bar (150 MPa - 21,755PSI)

Flow size - Nennweite  
rtc 081.04 4 mm

**Technical Specifications & Advantages**

- Ultimate High Pressure (UHP) dripless hydraulic coupling.
- Plug and Coupler has plastic dust cap in order to increase the service life.
- Dripless connection and disconnection
- Aluminium Dust cap is also available.



**HYDRAULIC**

Ultimate High Pressure (UHP)

TYPE 083 **rtc**



Compatible - Kompatibilität - Muadil  
Cejn 125

Temperature Range - Temperaturbereich - Sıcaklık Aralığı  
-20°C +100°C (-4°F +212°F) Nitril (N)

Working Pressure - Betriebsdruck  
2.000 bar (200 MPa - 29,000 PSI)

Flow size - Nennweite  
rtc 083.04 4 mm

**Technical Specifications & Advantages**

- Ultimate High Pressure (UHP) dripless hydraulic coupling.
- Plug and Coupler has plastic dust cap in order to increase the service life.
- Dripless connection and disconnection
- Aluminium Dust cap is also available.



**HYDRAULIC**

**rtc** TYPE 123

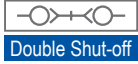

Temperature Range - Temperaturbereich - Sıcaklık Aralığı

-20°C +100°C (-4°F +212°F) Nitrile (N)  
 -10°C +180°C (+14°F +356°F) FPM (V)  
 -20°C +150°C (-4°F +302°F) EPDM (E)  
 0°C +250°C (-40°F +482°F) FFKM (W)  
 -40°C +175°C (-40°F +347°F) FMQ (SN)

Max. Working Pressure - Max. Betriebsdruck - Max. Çalışma Basıncı  
 260 bar (3770 PSI)

Flow size - Nennweiten - Akış Çapı

**rtc** 123.03 3 mm  
**rtc** 123.05 5 mm  
**rtc** 123.08 8 mm



Compatible - Kompatibilität - Muadil  
 Walther 11 Type

Temperature Range - Temperaturbereich - Sıcaklık Aralığı  
 -20°C +325°C (-4°F +617°F) FFKM (W)

Max. Working Pressure - Max. Betriebsdruck - Max. Çalışma Basıncı  
 20 bar (290 PSI)

Flow size - Nennweiten - Akış Çapı

**rtc** 219.12 12 mm  
**rtc** 219.19 19 mm

Using Area

For Hot Oil Usages - Für heiße Öl Anwendungen -  
 Kızgın Yağ Kullanımı için

High Temperature

TYPE 219 **rtc**



**HYDRAULIC**



**rtc** TYPE 127

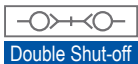

Temperature Range - Temperaturbereich - Sıcaklık Aralığı

-20°C +100°C (-4°F +212°F) Nitril (N)  
 -10°C +180°C (+14°F +356°F) FPM (V)  
 -50°C +150°C (-58°F +302°F) EPDM (E)

Max. Working Pressure - Max. Betriebsdruck - Max. Çalışma Basıncı  
 10 bar (145 PSI)

Flow size - Nennweiten - Akış Çapı

**rtc** 127.37 37 mm



Self Venting Safety Type

Sicherheitskupplung mit Vorentlüftungsfunktion

Hava Tahliyesi Emniyetli Tip

- The system perfectly fits to the ISO 4414, EN 983 safety standards.
- Full flow, negligible loss of pressure
- Simple operation, no force required
- Compact design

Temperature Range - Temperaturbereich - Sıcaklık Aralığı

-20°C +100°C (-4°F +212°F) Nitril (N)

-10°C +180°C (+14°F +356°F) FPM (V)

Max.Working Pressure - Max. Betriebsdruck - Max. Çalışma Basıncı

25 bar (365 PSI)

15 bar (220 PSI) Connection / Disconnection

Flow size - Nennweiten - Akış Çapı

3 mm	rtc 461
5.5 mm	rtc 460 / 461 / 462 / 466 / 467
8 mm	rtc 460 / 461 / 463 / 464 / 465 / 468 / 469
11 mm	rtc 460 / 461
19 mm	rtc 461

Connection - Anschluss - Bağlantı

1/8
1/4
3/8
1/2
3/4



Swing Coupler

TYPE 460-468

rtc



PNEUMATIC

rtc TYPE 450

Sleeve Twist Coupler



Self Venting Safety Type

Sicherheitskupplung mit Vorentlüftungsfunktion

Hava Tahliyesi Emniyetli Tip

- The system perfectly fits to the ISO 4414, EN 983 safety standards.
- Model to ISO 6150-C-10 and AFNOR: C-10 NF E 49-053
- Safety feature: 2-stage disconnection

Temperature Range - Temperaturbereich - Sıcaklık Aralığı

-20°C +100°C (-4°F +212°F) Nitril (N)

-10°C +180°C (+14°F +356°F) FPM (V)

Max.Working Pressure - Max. Betriebsdruck - Max. Çalışma Basıncı

25 bar (365 PSI)

15 bar (220 PSI) Connection/Disconnection

Flow size - Nennweiten - Akış Çapı

rtc 450.03	3 mm
rtc 450.06	5.5 mm
rtc 450.08	8 mm
rtc 450.11	11 mm

Connection - Anschluss - Bağlantı

1/8
1/4
3/8
1/2



PNEUMATIC

Self Venting Safety Type

Sicherheitskupplung mit Vorentlüftungsfunktion

Hava Tahliyesi Emniyetli Tip

- The system perfectly fits to the ISO 4414, EN 983 safety standards.
- Model to ISO 6150-C-10 and AFNOR: C-10 NF E 49-053
- Safety feature: 2-stage disconnection

Temperature Range - Temperaturbereich - Sıcaklık Aralığı

-20°C +100°C (-4°F +212°F) Nitril (N)

-10°C +180°C (+14°F +356°F) FPM (V)

Max.Working Pressure - Max. Betriebsdruck - Max. Çalışma Basıncı

25 bar (365 PSI)

15 bar (220 PSI) Connection/Disconnection

Flow size - Nennweiten - Akış Çapı

rtc 451.06	5.5 mm
rtc 451.08	8 mm
rtc 451.11	11 mm

Connection - Anschluss - Bağlantı

1/4
3/8
1/2

Sleeve Twist Coupler

TYPE 451

rtc



PNEUMATIC

**rtc** TYPE 452

Sleeve Twist Coupler



Self Venting Safety Type  
Sicherheitskupplung mit Vorentlüftungsfunktion  
Hava Tahliyelili Emniyetli Tip

- The system perfectly fits to the **ISO 4414, EN 983** safety standards.
- Model to ISO 6150-C-10 and AFNOR: C-10 NF E 49-053
- Safety feature: 2-stage disconnection
- Coded type (Non-Interchangeable)

Temperature Range - Temperaturbereich - Sıcaklık Aralığı  
-20°C +100°C (-4°F +212°F) Nitril (N)  
-10°C +180°C (+14°F +356°F) FPM (V)

Max.Working Pressure - Max. Betriebsdruck - Max. Çalışma Basıncı  
25 bar (365 PSI)  
15 bar (220 PSI) Connection/Disconnection

Flow size - Nennweiten - Akış Çapı  
**rtc** 452.06 5.5 mm

Connection - Anschluss - Bağlantı  
1/4

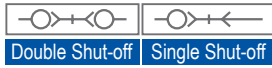

**PNEUMATIC**

Self Venting Type  
Sicherheits - Schnellkupplung  
Hava Tahliyelili Tip

- The system perfectly fits to the **ISO 4414, EN 983** safety standards.
- Safety feature: 2-stage disconnection
- Coded type (Non-Interchangeable) is also available.

Temperature Range - Temperaturbereich - Sıcaklık Aralığı  
-20°C +100°C (-4°F +212°F) Nitril (N)  
-10°C +180°C (+14°F +356°F) FPM (V)  
-20°C +150°C (-4°F +302°F) EPDM (E)

Max.Working Pressure - Max. Betriebsdruck - Max. Çalışma Basıncı  
25 bar (365 PSI)

Flow size - Nennweiten - Akış Çapı  
**rtc** 453.11 11 mm  
**rtc** 453.19 19 mm

Connection - Anschluss - Bağlantı  
1/2  
3/4

Heavy Duty Coupler

TYPE 453 **rtc**

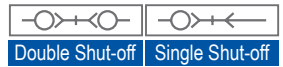
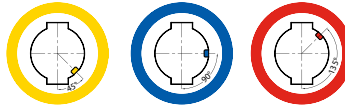

**WATER**  
**PNEUMATIC**

**rtc** TYPE 171



Self Venting Safety Type  
Sicherheitskupplung mit Vorentlüftungsfunktion  
Hava Tahliyelili Emniyetli Tip

- The system perfectly fits to the **ISO 4414, EN 983** safety standards requirements.

Temperature Range - Temperaturbereich - Sıcaklık Aralığı  
-20°C +100°C (-4°F +212°F) Nitril (N)  
-10°C +180°C (+14°F +356°F) FPM (V)

Max.Working Pressure - Max. Betriebsdruck - Max. Çalışma Basıncı

**rtc** 171.06 12 bar (175 PSI)  
**rtc** 171.08 16 bar (230 PSI)  
**rtc** 171.11 16 bar (230 PSI)

Flow size - Nennweiten - Akış Çapı

**rtc** 171.06 6 mm  
**rtc** 171.08 8 mm  
**rtc** 171.11 11 mm



**PNEUMATIC**

TYPE 002 **rtc**

Compatible - Kompatibilität - Muadil

**rtc** 463.08  
**rtc** 025  
**rtc** 026  
Rectus 25 & 26  
Cejn 320

Temperature Range - Temperaturbereich - Sıcaklık Aralığı  
-20°C +100°C (-4°F +212°F) Nitril (N)

Max.Working Pressure - Max. Betriebsdruck - Max. Çalışma Basıncı  
35 bar (510 PSI)

Flow size - Nennweiten - Akış Çapı  
**rtc** 002 7.2 mm



PNEUMATIC

**rtc** TYPE 013



Compatible - Kompatibilität - Muadil

Nitto Kohki Hi Cupla & Hi Cupla 200  
Rectus 13  
Cejn 315

Temperature Range - Temperaturbereich - Sıcaklık Aralığı  
-20°C +100°C (-4°F +212°F) Nitril (N)

Max.Working Pressure - Max. Betriebsdruck - Max. Çalışma Basıncı  
35 bar (510 PSI)

Flow size - Nennweiten - Akış Çapı  
**rtc** 013 7.5 mm



PNEUMATIC

TYPE 020 **rtc**

Compatible - Kompatibilität - Muadil

For Full-Flow and Single Shut-off

Rectus 20  
Walther 06-003

For Double Shut-off

Rectus 20KB  
Walther 06-003

Temperature Range - Temperaturbereich - Sıcaklık Aralığı  
-20°C +100°C (-4°F +212°F) Nitril (N)

Max.Working Pressure - Max. Betriebsdruck - Max. Çalışma Basıncı  
35 bar (510 PSI)

Flow size - Nennweiten - Akış Çapı  
**rtc** 020 2.7 mm

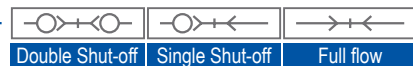

WATER PNEUMATIC

**rtc** TYPE 021



Compatible - Kompatibilität - Muadil  
For Full-Flow and Single Shut-off  
Rectus 21  
Camozzi

For Double Shut-off  
Rectus 21KB

Temperature Range - Temperaturbereich - Sıcaklık Aralığı  
-20°C +100°C (-4°F +212°F) Nitril (N)

Max.Working Pressure - Max. Betriebsdruck - Max. Çalışma Basıncı  
35 bar (510 PSI)

Flow size - Nennweiten - Akış Çapı  
**rtc** 021 5 mm



Single Shut-off Full flow

**WATER**  
**PNEUMATIC**

TYPE 022 **rtc**



Compatible - Kompatibilität - Muadil

**rtc** 462.06  
**rtc** 014  
AMFLO C38  
ARO 210  
Cejn 300  
Foster 210  
Parker B53  
Rectus 14 & 22

Temperature Range - Temperaturbereich - Sıcaklık Aralığı  
-20°C +100°C (-4°F +212°F) Nitril (N)

Max.Working Pressure - Max. Betriebsdruck - Max. Çalışma Basıncı  
35 bar (510 PSI)

Flow size - Nennweiten - Akış Çapı  
**rtc** 022 5.5 mm



Single Shut-off Full flow

**PNEUMATIC**

**rtc** TYPE 023



Compatible - Kompatibilität - Muadil

US (Industrial) MIL-C-4109 1/4  
ISO 6150-B-12  
**rtc** 460.06  
Hansen 1000  
Cejn 310  
Foster 3003  
Parker B23  
Rectus 23 & 24

Temperature Range - Temperaturbereich - Sıcaklık Aralığı  
-20°C +100°C (-4°F +212°F) Nitril (N)

Max.Working Pressure - Max. Betriebsdruck - Max. Çalışma Basıncı  
35 bar (510 PSI)

Flow size - Nennweiten - Akış Çapı  
**rtc** 023 5.5 mm



Single Shut-off Full flow

**PNEUMATIC**

TYPE 025 **rtc**

Compatible - Kompatibilität - Muadil  
For Full-Flow and Single Shut-off

rtc 463.08  
rtc 026  
Rectus 25 & 26  
Cejn 320

For Double Shut-off

Rectus 25KB & 26KB

Temperature Range - Temperaturbereich - Sıcaklık Aralığı  
-20°C +100°C (-4°F +212°F) Nitril (N)

Max.Working Pressure - Max. Betriebsdruck - Max. Çalışma Basıncı  
35 bar (510 PSI)

Flow size - Nennweiten - Akış Çapı  
rtc 025 7.8 mm

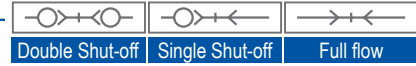

PNEUMATIC

**rtc** TYPE 026



Compatible - Kompatibilität - Muadil  
For Full-Flow and Single Shut-off

rtc 463.08  
rtc 025  
Rectus 25 & 26  
Cejn 320

For Double Shut-off

Rectus 25KB & 26KB

Temperature Range - Temperaturbereich - Sıcaklık Aralığı  
-20°C +100°C (-4°F +212°F) Nitril (N)

Max.Working Pressure - Max. Betriebsdruck - Max. Çalışma Basıncı  
35 bar (510 PSI)

Flow size - Nennweiten - Akış Çapı  
rtc 026 7.2 mm



PNEUMATIC

TYPE 027 **rtc**

Compatible - Kompatibilität - Muadil  
For Full-Flow and Single Shut-off

Rectus 27  
Cejn 410  
Tema 1700

For Double Shut-off

Rectus 27KB

Temperature Range - Temperaturbereich - Sıcaklık Aralığı  
-20°C +100°C (-4°F +212°F) Nitril (N)

Max.Working Pressure - Max. Betriebsdruck - Max. Çalışma Basıncı  
35 bar (510 PSI)

Flow size - Nennweiten - Akış Çapı  
rtc 027 10 mm

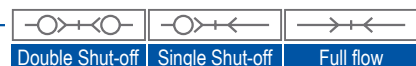

PNEUMATIC



**rtc** TYPE 033



Compatible - Kompatibilität - Muadil

<b>rtc</b>	468.08
Atlas Copco	QIC10
Rectus	33

Temperature Range - Temperaturbereich - Sıcaklık Aralığı  
-20°C +100°C (-4°F +212°F) Nitril (N)

Max.Working Pressure - Max. Betriebsdruck - Max. Çalışma Basıncı  
35 bar (510 PSI)

Flow size - Nennweiten - Akış Çapı  
**rtc** 033 8.5 mm



**PNEUMATIC**

TYPE 038 **rtc**



Compatible - Kompatibilität - Muadil

<b>rtc</b>	038.15	<b>rtc</b>	038.19
Rectus	38 - 38KB	Rectus	39 - 39KB
Hansen	6000	Hansen	7000

Temperature Range - Temperaturbereich - Sıcaklık Aralığı  
-20°C +100°C (-4°F +212°F) Nitril (N)

Max.Working Pressure - Max. Betriebsdruck - Max. Çalışma Basıncı  
35 bar (510 PSI)

Flow size - Nennweiten - Akış Çapı  
**rtc** 038.15 15 mm  
**rtc** 038.19 19 mm



**WATER**  
**PNEUMATIC**

**rtc** TYPE 042



Compatible - Kompatibilität - Muadil

Parker	42
--------	----

Temperature Range - Temperaturbereich - Sıcaklık Aralığı  
-20°C +100°C (-4°F +212°F) Nitril (N)  
-10°C +180°C (+14°F +356°F) FPM (V)

Max.Working Pressure - Max. Betriebsdruck - Max. Çalışma Basıncı  
16 bar (230 PSI)

Flow size - Nennweiten - Akış Çapı  
**rtc** 042.12 12 mm



**WATER**

TYPE 043 **rtc**

Compatible - Kompatibilität - Muadil  
Legris 8500L

Temperature Range - Temperaturbereich - Sıcaklık Aralığı  
-20°C +100°C (-4°F +212°F) Nitril (N)  
-10°C +180°C (+14°F +356°F) FPM (V)

Max.Working Pressure - Max. Betriebsdruck - Max. Çalışma Basıncı  
15 bar (215 PSI) - For brass

Flow size - Nennweiten - Akış Çapı  
**rtc** 043.12 12 mm  
**rtc** 043.19 19 mm



WATER

**rtc** TYPE 044



Temperature Range - Temperaturbereich - Sıcaklık Aralığı  
-20°C +100°C (-4°F +212°F) Nitril (N)  
-10°C +180°C (+14°F +356°F) FPM (V)

Max.Working Pressure - Max. Betriebsdruck - Max. Çalışma Basıncı  
15 bar (215 PSI) - For brass

Flow size - Nennweiten - Akış Çapı  
**rtc** 044.11 11 mm  
**rtc** 044.16 16 mm  
**rtc** 044.19 19 mm

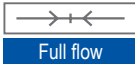

WATER

Compatible - Kompatibilität - Muadil  
Parker ST  
Hansen ST

Temperature Range - Temperaturbereich - Sıcaklık Aralığı  
-20°C +100°C (-4°F +212°F) Nitril (N)  
-10°C +180°C (+14°F +356°F) FPM (V)  
-50°C +150°C (-58°F +302°F) EPDM (E)

Max.Working Pressure - Max. Betriebsdruck - Max. Çalışma Basıncı  
70 - 310 bar (510 PSI) - For brass  
140 - 350 bar - (2025 - 5075 PSI) For Steel  
100 - 450 bar - (1450 - 6525 PSI) For Stainless-steel

Flow size - Nennweiten - Akış Çapı  
**rtc** 045.04 4 mm  
**rtc** 045.06 6.5 mm  
**rtc** 045.10 9.5 mm  
**rtc** 045.13 12.7 mm  
**rtc** 045.19 19 mm  
**rtc** 045.25 25 mm  
**rtc** 045.33 33 mm  
**rtc** 045.37 37 mm



TYPE 045 **rtc**



WATER  
PNEUMATIC  
HYDRAULIC

**rtc** TYPE 046



Compatible - Kompatibilität - Muadil  
Snap Tite H

Temperature Range - Temperaturbereich - Sıcaklık Aralığı  
-20°C +100°C (-4°F +212°F) Nitril (N)  
-10°C +180°C (+14°F +356°F) FPM (V)

Max.Working Pressure - Max. Betriebsdruck - Max. Çalışma Basıncı  
155 - 450 bar (400 - 2250 PSI) - Brass  
100 - 450 bar (1500 - 6500 PSI) - Steel  
35 - 350 bar (500 - 5000 PSI) - Stainless Steel  
20 - 155 bar (300 - 2250 PSI) - Aluminium

Flow size - Nennweiten - Akış Çapı

rtc 046.06	6 mm
rtc 046.09	9 mm
rtc 046.13	13 mm
rtc 046.19	19 mm
rtc 046.25	25 mm
rtc 046.30	30 mm
rtc 046.38	38 mm
rtc 046.50	50 mm

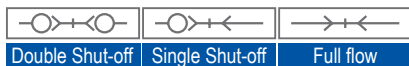

Compatible - Kompatibilität - Muadil  
Nitto Kohki TSP

Temperature Range - Temperaturbereich - Sıcaklık Aralığı  
-20°C +100°C (-4°F +212°F) Nitril (N)  
-10°C +180°C (+14°F +356°F) FPM (V)

Max.Working Pressure - Max. Betriebsdruck - Max. Çalışma Basıncı  
30 - 50 bar (435 - 725 PSI) - For brass  
45 - 100 bar (650 - 1.450 PSI) - Stainless Steel

Flow size - Nennweiten - Akış Çapı

rtc 053.06	6 mm
rtc 053.10	10 mm
rtc 053.13	13 mm
rtc 053.19	19 mm
rtc 053.25	25 mm



TYPE 053 **rtc**

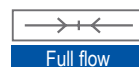

**rtc** TYPE 092 Knock-out Coupler / Ejector Coupler



Pneumatic Series

Advantages

- Quick and easy installation
- Return of the ejector plate is assured
- Part ejection is assured
- Coupling is obtained in any position, disconnecting is made only after the ejector plate is fully returned.
- Fast acting, up to 30 strokes per minute.
- Can be used on all injection machines equipped with hydraulic or mechanical ejection
- Set-up time can be greatly reduced.
- Reduced noise on machines with mechanical knockouts
- Especially suited for injection machines that do not have easy access to the ejector plate.

Compatible - Kompatibilität - Muadil

Max.Pull Force - Max.Zugkraft - Max. Çekme Kuvveti

rtc 092.16	1500 kg	Alba 300 Series
rtc 092.18	2400 kg	Alba 400 Series
rtc 092.19	1500 kg	Pneumatic Series
rtc 092.25	3200 kg	Alba 500 Series
rtc 092.36	6000 kg	Pneumatic Series

Vorteile

- Schnelle und einfache Installation
- Die Rückkehr der Auswurfplatte ist gewährleistet
- Teil Ausstoß ist gewährleistet
- Die Kupplung wirkt in jeder Position - Trennung erfolgt erst wenn die Auswurfplatte voll zurück gefahren ist
- Schnelle Funktionalität - bis zu 30 Hübe pro Monute
- Kann auf alle Spritzgussmaschinen ausgestattet werden mit hydraulischen oder mechanischen Auswurf
- Rüstzeit kann erheblich verkürzt werden
- Speziell für Spritzgussmaschinen mit schwer zugänglicher Auswurfplatte

**ACCESSORIES**

TYPE BC & BCO **rtc**

Pressure Plug with Copper Washer  
Verschlussstopfen mit Kupferscheibe  
Bakır Pullu Kör Tıpa

PPD 10	BSP 1/8
PPD 13	BSP 1/4
PPD 17	BSP 3/8
PPD 21	BSP 1/2
PPD 26	BSP 3/4
PPD 33	BSP 1
PPD 1010	M10x1
PPD 1215	M12x1.5
PPD 1415	M14x1.5
PPD 1615	M16x1.5
PPD 2215	M22x1.5
PPD 2415	M24x1.5



Threadless Pressure Plug  
Verschlussstopfen ohne Gewinde  
Dişsiz Kör Tıpa

Compatible - Austauschbar - Muadil  
Hasco Z 942

1. Material: Ms58 Brass - Messing
2. Material: Inner Part Stainless Steel - Edelstahl

BC - 06
BC - 08
BC - 10
BC - 11
BC - 12
BC - 14
BC - 15
BC - 16
BC - 20



Threadless Pressure Plug with O-Ring  
Verschlussstopfen mit O-Ring  
O-Ringli Kör Tıpa

Compatible - Austauschbar - Muadil  
EOC KN / 105

Material: Ms58 Brass - Messing  
O-Ring: Viton  
Max. Temp: 180°C

BCO - 06
BCO - 07
BCO - 08
BCO - 8.5
BCO - 10
BCO - 11.5
BCO - 12
BCO - 14
BCO - 15



BCO - 16
BCO - 20
BCO - 22
BCO - 25

ACCESSORIES **rtc**

**rtc** TYPE NOP & PPG & PPR

NOP 10/06	BSP 1/8	4x6 mm
NOP 10/08	BSP 1/8	6x8 mm
NOP 10/10	BSP 1/8	8x10 mm
NOP 13/06	BSP 1/4	4x6 mm
NOP 13/08	BSP 1/4	6x8 mm
NOP 13/10	BSP 1/4	8x10 mm
NOP 13/12	BSP 1/4	9x12 mm
NOP 17/06	BSP 3/8	4x6 mm
NOP 17/08	BSP 3/8	6x8 mm
NOP 17/10	BSP 3/8	8x10 mm
NOP 17/12	BSP 3/8	9x12 mm
NOP 21/08	BSP 1/2	6x8 mm
NOP 21/10	BSP 1/2	8x10 mm
NOP 21/12	BSP 1/2	9x12 mm



Material: Ms58 Brass - Messing  
Plate: Nickel Plated - Verzinkt

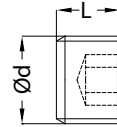

Material: Ms58 Brass - Messing

PPG 10	BSP 1/8
PPG 13	BSP 1/4
PPG 17	BSP 3/8
PPG 21	BSP 1/2
PPM 0875	M8x075
PPM 1010	M10x1
PPM 1215	M12x1.5
PPM 1415	M14x1.5
PPM 1615	M16x1.5
PPM 2015	M20x1.5

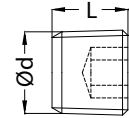

Material: Ms58 Brass - Messing

PPR 10	BSPT 1/8
PPR 13	BSPT 1/4
PPR 17	BSPT 3/8
PPR 21	BSPT 1/2
PPK 0875	M8x075
PPK 1010	M10x1
PPK 1215	M12x1.5
PPK 1415	M14x1.5
PPK 1615	M16x1.5
PPK 2015	M20x1.5

ACCESSORIES **rtc**

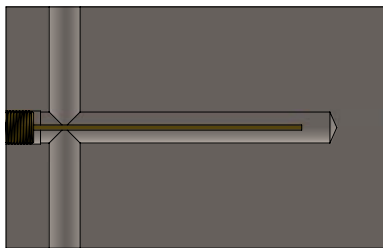

Straight Baffle (SBM)

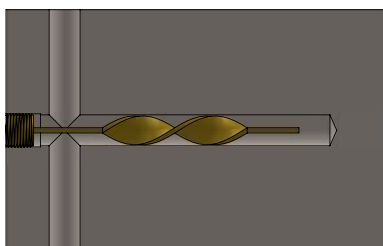

Turbo Baffle (TBM)

Baffles

TYPE SBM & TBM **rtc**



ACCESSORIES **rtc**

**rtc** TYPE CPE & CPW2 & SRM & SRG



Ear Hose Clamp  
Ohr-Schlauchschellen  
Kulaklı Hortum Kelepçesi

Material: Zinc Plated Steel

- CPE - 0709
- CPE - 0911
- CPE - 1315
- CPE - 1417
- CPE - 1518
- CPE - 1720
- CPE - 1821
- CPE - 2023



Hose Clamp - Schlauchschellen  
Hortum Kelepçesi

Material:

Screw - Zinc Plated Steel  
Housing - Stainless Steel  
Band - Stainless Steel

- CPW2 - 0812 - 09
- CPW2 - 1016 - 09
- CPW2 - 1220 - 09
- CPW2 - 1627 - 09
- CPW2 - 2032 - 09
- CPW2 - 2540 - 09

- |              |           |
|--------------|-----------|
| SRM 08 x 38  | M 8x1.25  |
| SRM 08 x 60  | M 8x1.25  |
| SRM 08 x 80  | M 8x1.25  |
| SRM 08 x 100 | M 8x1.25  |
| SRM 10 x 38  | M 10x1.5  |
| SRM 10 x 60  | M 10x1.5  |
| SRM 10 x 80  | M 10x1.5  |
| SRM 10 x 100 | M 10x1.5  |
| SRM 10 x 120 | M 10x1.5  |
| SRM 10 x 150 | M 10x1.5  |
| SRM 12 x 38  | M 12x1.75 |
| SRM 12 x 60  | M 12x1.75 |
| SRM 12 x 80  | M 12x1.75 |
| SRM 12 x 100 | M 12x1.75 |
| SRM 12 x 120 | M 12x1.75 |
| SRM 12 x 150 | M 12x1.75 |
| SRM 14 x 38  | M 14x2.0  |



Extension Hose Plugs - Verlängerungsnippel - Uzatma Hortum Uç  
Material: Ms58 Brass - Messing - Piriç

- |              |         |
|--------------|---------|
| SRG 10 x 38  | BSP 1/8 |
| SRG 10 x 60  | BSP 1/8 |
| SRG 10 x 80  | BSP 1/8 |
| SRG 10 x 100 | BSP 1/8 |
| SRG 10 x 120 | BSP 1/8 |
| SRG 10 x 150 | BSP 1/8 |
| SRG 13 x 38  | BSP 1/4 |
| SRG 13 x 60  | BSP 1/4 |
| SRG 13 x 80  | BSP 1/4 |
| SRG 13 x 100 | BSP 1/4 |
| SRG 13 x 120 | BSP 1/4 |
| SRG 13 x 150 | BSP 1/4 |

**ACCESSORIES**

TYPE MMN & MFN & EBFM **rtc**

Male - Female Thread Adapter  
Aussen - Innengewinde Adapter  
Erkek - Dişi Diş Adaptörü

Material: Ms58 Brass  
Messing - Piriç



- |               |         |         |
|---------------|---------|---------|
| MFN 13-10     | BSP 1/4 | BSP 1/8 |
| MFN 17-13     | BSP 3/8 | BSP 1/4 |
| MFN 21-17     | BSP 1/2 | BSP 3/8 |
| MFN 26-21     | BSP 3/4 | BSP 1/2 |
| MFN 1415-1010 | M14x1.5 | M10x1   |
| MFN 1815-1415 | M18x1.5 | M14x1.5 |
| MFN 2415-1615 | M24x1.5 | M16x1.5 |

(DIN 3863) Male Thread Adapter with Inner Cone  
Aussengewinde Doppelnippel mit Innenkonus  
Erkek Diş Adaptörü İç Konik

Material: Ms58 Brass  
Messing - Piriç



- |               |         |         |
|---------------|---------|---------|
| MMN10-10      | BSP 1/8 | BSP 1/8 |
| MMN13-13      | BSP 1/4 | BSP 1/4 |
| MMN 17-17     | BSP 3/8 | BSP 3/8 |
| MMN 21-21     | BSP 1/2 | BSP 1/2 |
| MMN 26-26     | BSP 3/4 | BSP 3/4 |
| MMN 13-1415   | BSP 1/4 | M14x1.5 |
| MMN 17-1615   | BSP 3/8 | M16x1.5 |
| MMN 21-1815   | BSP 1/2 | M18x1.5 |
| MMN 26-2415   | BSP 3/4 | M24x1.5 |
| MMN 1415-1415 | M14x1.5 | M14x1.5 |
| MMN 1615-1615 | M16x1.5 | M16x1.5 |

45° & 90° Male to Female Elbow  
Innen - Aussengewinde Winkel  
İç - Diş Dişli Dirsek

Material: Ms58 Brass - Messing - Piriç

- |              |         |
|--------------|---------|
| EBFM 10 - 90 | BSP 1/8 |
| EBFM 13 - 90 | BSP 1/4 |
| EBFM 17 - 90 | BSP 3/8 |
| EBFM 21 - 90 | BSP 1/2 |
| EBFM 26 - 90 | BSP 3/4 |
| EBFM 33 - 90 | BSP 1   |
| EBFM 10 - 45 | BSP 1/8 |
| EBFM 13 - 45 | BSP 1/4 |
| EBFM 17 - 45 | BSP 3/8 |
| EBFM 21 - 45 | BSP 1/2 |
| EBFM 26 - 45 | BSP 3/4 |
| EBFM 33 - 45 | BSP 1   |



**ACCESSORIES**

**rtc** TYPE SPN

Swivel PushLock Hose Nippel



Material: Steel - Stahl  
Plate: Zinc

- |             |         |            |
|-------------|---------|------------|
| SPN 1215-06 | M12x1.5 | 1/4 - 6.3  |
| SPN 1415-06 | M14x1.5 | 1/4 - 6.3  |
| SPN 1615-10 | M16x1.5 | 3/8 - 9.5  |
| SPN 1815-10 | M18x1.5 | 3/8 - 9.5  |
| SPN 2215-13 | M22x1.5 | 1/2 - 12.7 |
| SPN 2615-16 | M26x1.5 | 5/8 - 15.9 |
| SPN 3020-19 | M30x2.0 | 3/4 - 19.1 |
| SPN 3620-25 | M36x2.0 | 1 - 25.4   |



Material: Steel - Stahl  
Plate: Zinc

- |                |         |            |
|----------------|---------|------------|
| SPN 1215-06-45 | M12x1.5 | 1/4 - 6.3  |
| SPN 1415-06-45 | M14x1.5 | 1/4 - 6.3  |
| SPN 1615-10-45 | M16x1.5 | 3/8 - 9.5  |
| SPN 1815-10-45 | M18x1.5 | 3/8 - 9.5  |
| SPN 2215-13-45 | M22x1.5 | 1/2 - 12.7 |
| SPN 2615-16-45 | M26x1.5 | 5/8 - 15.9 |
| SPN 3020-19-45 | M30x2.0 | 3/4 - 19.1 |
| SPN 3620-25-45 | M36x2.0 | 1 - 25.4   |



Material: Steel - Stahl  
Plate: Zinc

- |                |         |            |
|----------------|---------|------------|
| SPN 1215-06-90 | M12x1.5 | 1/4 - 6.3  |
| SPN 1415-06-90 | M14x1.5 | 1/4 - 6.3  |
| SPN 1615-10-90 | M16x1.5 | 3/8 - 9.5  |
| SPN 1815-10-90 | M18x1.5 | 3/8 - 9.5  |
| SPN 2215-13-90 | M22x1.5 | 1/2 - 12.7 |
| SPN 2615-16-90 | M26x1.5 | 5/8 - 15.9 |
| SPN 3020-19-90 | M30x2.0 | 3/4 - 19.1 |
| SPN 3620-25-90 | M36x2.0 | 1 - 25.4   |

**ACCESSORIES**

TYPE MHN & FHN & HHN **rtc**

Male and Female Hose Nipples with 8 Different Hose-Connection Types  
8 Schlauchanschlusstypen mit Innen- und Aussengewinde  
8 Farklı hortum bağlantı profilili Erkek ve Dişi Vidalı uçlar

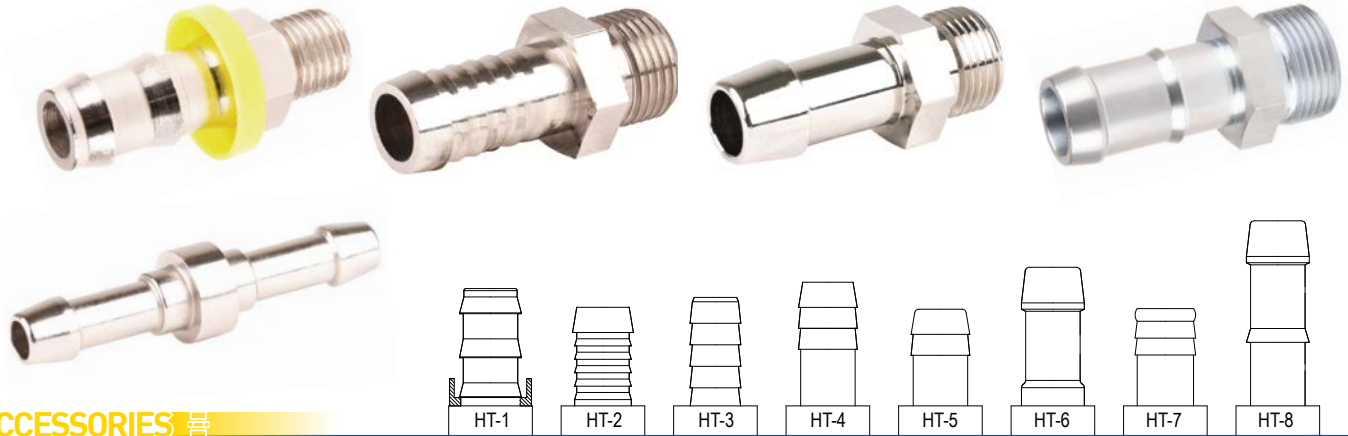

ACCESSORIES **rtc**

**rtc** TYPE 117 & 118

**rtc** type 117  
Brass Collector  
Messing Verteiler  
Pirinç Kollektör

Inlet / Einlass  
3/4"  
1"  
1-1/4"

Outlet / Auslass  
1/4" & 3/8"  
1/4" & 3/8" & 1/2"  
3/8" & 1/2" & 3/4"

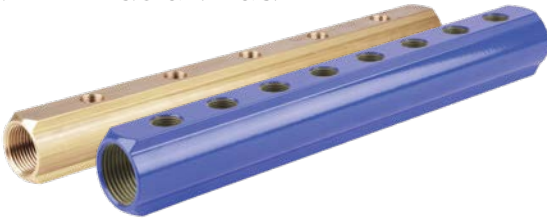

**rtc** type 118  
5 Surfaced Aluminium Collector  
5 Seitiger Aluminium Verteiler  
5 Yüzlü Alüminyum Kollektör

Inlet / Einlass  
3/4"  
1"  
1-1/4"  
1-1/2"  
2"

Outlet / Auslauf  
1/4" & 3/8"  
1/4" & 3/8"  
1/4" & 3/8" & 1/2"  
3/8" & 1/2"  
3/8" & 1/2" & 3/4"



**WATER**  
**PNEUMATIC**

TYPE 119 **rtc**

**rtc** type 119  
3 Surfaced Stainless Steel Collector  
3 Seitiger Edelstahl Verteiler  
3 Yüzlü Paslanmaz Çelik Kollektör

Inlet / Einlass  
1"  
1-1/4"  
1-1/2"

Outlet / Auslauf  
1/4" & 3/8" & 1/2"  
1/4" & 3/8" & 1/2"  
1/4" & 3/8" & 1/2"

Options

Low port thread is shown on the picture.

- High port thread,
- Twin profile, (max. 2 Surfaced hole is available)
- Divided profile are available.



**rtc** TYPE Ball Valves Male - Female



T Handle Ball Valve

Order No / Bestellnr.		Connection Anschluss
Red / Rot	Blue/ Blau	
TVFM 13-R	TVFM 13-B	BSP 1/4
TVFM 17-R	TVFM 17-B	BSP 3/8
TVFM 21-R	TVFM 21-B	BSP 1/2
TVFM 26-R	TVFM 26-B	BSP 3/4
TVFM 33-R	TVFM 33-B	BSP 1
TVFM 42-R	TVFM 42-B	BSP 1-1/4



Standard Ball Valve

Order No / Bestellnr.		Connection Anschluss
Red / Rot	Blue/ Blau	
SVFM 13-R	SVFM 13-B	BSP 1/4
SVFM 17-R	SVFM 17-B	BSP 3/8
SVFM 21-R	SVFM 21-B	BSP 1/2
SVFM 26-R	SVFM 26-B	BSP 3/4
SVFM 33-R	SVFM 33-B	BSP 1
SVFM 42-R	SVFM 42-B	BSP 1-1/4
SVFM 48-R	SVFM 48-B	BSP 1-1/2



Mini Ball Valve

Order No / Bestellnr.		Connection Anschluss
Red / Rot	Blue/ Blau	
KVFM 13-R	KVFM 13-B	BSP 1/4
KVFM 17-R	KVFM 17-B	BSP 3/8
KVFM 21-R	KVFM 21-B	BSP 1/2
KVFM 26-R	KVFM 26-B	BSP 3/4

**ACCESSORIES**

TYPE Ball Valves Female - Female **rtc**



T Handle Ball Valve

Order No / Bestellnr.		Connection Anschluss
Red / Rot	Blue/ Blau	
TVFF 13-R	TVFF 13-B	BSP 1/4
TVFF 17-R	TVFF 17-B	BSP 3/8
TVFF 21-R	TVFF 21-B	BSP 1/2
TVFF 26-R	TVFF 26-B	BSP 3/4
TVFF 33-R	TVFF 33-B	BSP 1
TVFF 42-R	TVFF 42-B	BSP 1-1/4



Standard Ball Valve

Order No / Bestellnr.		Connection Anschluss
Red / Rot	Blue/ Blau	
SVFF 13-R	SVFF 13-B	BSP 1/4
SVFF 17-R	SVFF 17-B	BSP 3/8
SVFF 21-R	SVFF 21-B	BSP 1/2
SVFF 26-R	SVFF 26-B	BSP 3/4
SVFF 33-R	SVFF 33-B	BSP 1
SVFF 42-R	SVFF 42-B	BSP 1-1/4
SVFF 48-R	SVFF 48-B	BSP 1-1/2



Mini Ball Valve

Order No / Bestellnr.		Connection Anschluss
Red / Rot	Blue/ Blau	
KVFF 13-R	KVFF 13-B	BSP 1/4
KVFF 17-R	KVFF 17-B	BSP 3/8
KVFF 21-R	KVFF 21-B	BSP 1/2
KVFF 26-R	KVFF 26-B	BSP 3/4

**ACCESSORIES**

**rtc** TYPE LOCK HOSE



Push To Connect (**rtc** LOCK) Type Hose

**Tube:** Hydraulic oil and water resistant special synthetic rubber

**Reinforcement:** High textile synthetic textile braid

**Cover:** Oil, abrasion, ozone and water resistant special synthetic rubber

**Application:** For hydraulic control lines, discharge under low pressure of hydraulic fluids, fuel oil, grease, air and water

Medium Temperature: Air 70°C - Water 90°C  
 Max. Bursting Pressure: 200 bar  
 Max. Working Pressure: 28 bar  
 Colors: Red, Blue, Black  
 Dimensions: 3/8 - 1/2 - 5/8 - 3/4



Temperature: **rtc** LOCK 90 -40°C +90°C (-40°F +194°F)  
**rtc** LOCK S-90 -40°C +90°C (-40°F +194°F)  
**rtc** LOCK S-140 -40°C +140°C (-40°F +284°F)

**ACCESSORIES**

EUROPEAN Type - EUROPÄISCHER Typ - AVRUPA Tip

Temperature Range - Temperaturbereich - Sıcaklık Aralığı  
-20°C +100°C (-4°F +212°F) Nitril (N)  
-10°C +180°C (+14°F +356°F) FPM (V)

Max.Working Pressure - Max. Betriebsdruck - Max. Çalışma basıncı  
16 bar (232 PSI)

Flow size - Nennweiten - Akış Çapı

**rtc M090.06\*** 6 mm  
**rtc M090.09\*** 9 mm  
**rtc M090.13\*** 13 mm

Connections - Anschlüsse - Bağlantı  
6 / 8 / 10 / 12 / 16 / 20 / 24

Circuits - Kreislauf - Giriş/Çıkış

3 ↔ 3 4 ↔ 4 5 ↔ 5 6 ↔ 6 8 ↔ 8 10 ↔ 10 12 ↔ 12

New Design

TYPE **M090** **rtc**



**WATER**  
**PNEUMATIC**

\*New Design - Neues Design - Yeni Tasarım



**rtc** TYPE **M099**

New Design



INTERNATIONAL Type - INTERNATIONAL Typ - ULUSLARARASI Tip

Temperature Range - Temperaturbereich - Sıcaklık Aralığı  
-20°C +100°C (-4°F +212°F) Nitril (N)  
-10°C +180°C (+14°F +356°F) FPM (V)

Max.Working Pressure - Max. Betriebsdruck - Max. Çalışma basıncı  
16 bar (232 PSI)

Flow size - Nennweiten - Akış Çapı

**rtc M099.06\*** 6 mm  
**rtc M099.09\*** 9 mm

Connections - Anschlüsse - Bağlantı  
6 / 8 / 10 / 12 / 16 / 20 / 24

Circuits - Kreislauf - Giriş/Çıkış

3 ↔ 3 4 ↔ 4 5 ↔ 5 6 ↔ 6 8 ↔ 8 10 ↔ 10 12 ↔ 12

\*New Design - Neues Design - Yeni Tasarım

**WATER**  
**PNEUMATIC**



Temperature Range - Temperaturbereich - Sıcaklık Aralığı

-20°C +100°C (-4°F +212°F) Nitril (N)  
-10°C +180°C (+14°F +356°F) FPM (V)

Max.Working Pressure - Max. Betriebsdruck - Max. Çalışma basıncı  
16 bar (232 PSI)

Flow size - Nennweiten - Akış Çapı

**rtc M101.06** 6 mm  
**rtc M101.09** 9 mm  
**rtc M101.10\*** 10 mm  
**rtc M101.12** 12 mm  
**rtc M101.16** 16 mm

Connections - Anschlüsse - Bağlantı  
6 / 8 / 10 / 12 / 16 / 20 / 24

Circuits - Kreislauf - Giriş/Çıkış

3 ↔ 3 4 ↔ 4 5 ↔ 5 6 ↔ 6 8 ↔ 8 10 ↔ 10 12 ↔ 12

TYPE **M101** **rtc**



**WATER**  
**PNEUMATIC**

\*New Design - Neues Design - Yeni Tasarım





**rtc** TYPE M150

Flat Faced Non-Spill Multi-Couplings  
 Flachdichtende Multikupplung in Lecksgefreier Ausführung  
 Düz Alınlı Damlatmasız Manifold

Temperature Range - Temperaturbereich - Sıcaklık Aralığı  
 -10°C +180°C (+14°F +356°F) FPM (V)

Max.Working Pressure - Max. Betriebsdruck - Max. Çalışma basıncı  
 16 bar (232 PSI)

Flow size - Nennweiten - Akış Çapı

rtc M150.09 9 mm  
 rtc M150.12 12 mm

Connections - Anschlüsse - Bağlantı

6 / 12 / 18

Circuits - Kreislauf - Giriş/Çıkış

3 ↔ 3 | 6 ↔ 6 | 9 ↔ 9

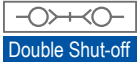

Double Shut-off

Flat Faced Non-Spill Multi-Couplings  
 Flachdichtende Multikupplung in Lecksgefreier Ausführung  
 Düz Alınlı Damlatmasız Manifold

Temperature Range - Temperaturbereich - Sıcaklık Aralığı  
 -10°C +180°C (+14°F +356°F) FPM (V)

Max.Working Pressure - Max. Betriebsdruck - Max. Çalışma basıncı  
 16 bar (232 PSI)

Flow size - Nennweiten - Akış Çapı

rtc M152.06 6 mm  
 rtc M152.10 10 mm  
 rtc M152.12 12 mm  
 rtc M152.16 16 mm

Connections - Anschlüsse - Bağlantı

6 / 8 / 10 / 12 / 16 / 20 / 24

Circuits - Kreislauf - Giriş/Çıkış

3 ↔ 3 | 4 ↔ 4 | 5 ↔ 5 | 6 ↔ 6 | 8 ↔ 8 | 10 ↔ 10 | 12 ↔ 12

New Design

TYPE M152 **rtc**

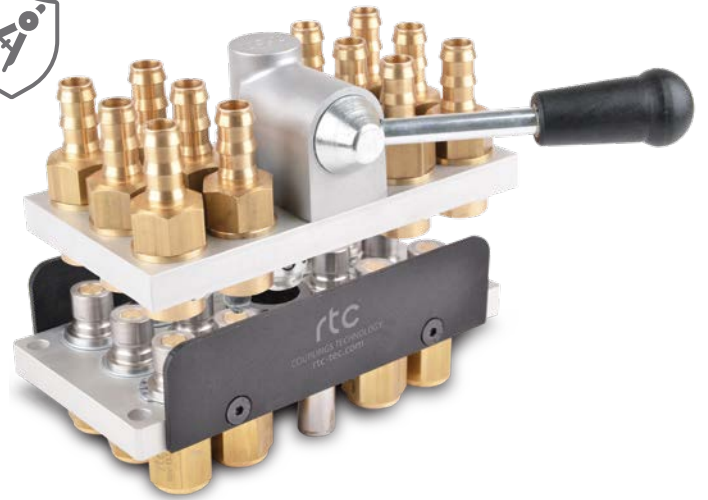

WATER

\*New Design - Neues Design - Yeni Tasarım



Double Shut-off

**rtc** TYPE M153

Flat Faced Non-Spill Multi-Couplings  
 Flachdichtende Multikupplung in Lecksgefreier Ausführung  
 Düz Alınlı Damlatmasız Manifold

Temperature Range - Temperaturbereich - Sıcaklık Aralığı  
 -10°C +180°C (+14°F +356°F) FPM (V)

Max.Working Pressure - Max. Betriebsdruck - Max. Çalışma basıncı  
 16 bar (232 PSI)

Flow size - Nennweiten - Akış Çapı

rtc M153.09 9 mm

Connections - Anschlüsse - Bağlantı

6 / 12 / 18

Circuits - Kreislauf - Giriş/Çıkış

3 ↔ 3 | 6 ↔ 6 | 9 ↔ 9



Double Shut-off



WATER

Residual Pressure Connection

Flat Faced Non-Spill Multi-Couplings  
Flachdichtende Multikupplung in Lecksgefreier Ausführung  
Düz Alınlı Damlatmasız Manifold

Temperature Range - Temperaturbereich - Sıcaklık Aralığı  
-20°C +100°C (-4°F +212°F) Nitril (N)  
-10°C +180°C (+14°F +356°F) FPM (V)

Max.Working Pressure - Max. Betriebsdruck - Max. Çalışma basıncı  
rtc M103.10 200 bar (2900 PSI)

Flow size - Nennweiten - Akış Çapı  
rtc M103.10 10 mm

Connections - Anschlüsse - Bağlantı  
2 / 4 / 6 / 8

Circuits - Kreislauf - Giriş/Çıkış  
1 ↔ 1 2 ↔ 2 3 ↔ 3 4 ↔ 4

New Design

TYPE M103 **rtc**

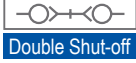

HYDRAULIC

**rtc** TYPE M104



Flat Faced Non-Spill Multi-Couplings  
Flachdichtende Multikupplung in Lecksgefreier Ausführung  
Düz Alınlı Damlatmasız Manifold

Temperature Range - Temperaturbereich - Sıcaklık Aralığı  
-20°C +100°C (-4°F +212°F) Nitril (N)  
-10°C +180°C (+14°F +356°F) FPM (V)

Max.Working Pressure - Max. Betriebsdruck - Max. Çalışma basıncı  
rtc M104.08 200 bar (2900 PSI)

Flow size - Nennweiten - Akış Çapı  
rtc M104.08 8 mm  
rtc M104.10 10 mm

Connections - Anschlüsse - Bağlantı  
2 / 4 / 6 / 8

Circuits - Kreislauf - Giriş/Çıkış  
1 ↔ 1 2 ↔ 2 3 ↔ 3 4 ↔ 4

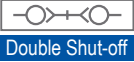

HYDRAULIC

Flat Faced Non-Spill Multi-Couplings  
Flachdichtende Multikupplung in Lecksgefreier Ausführung  
Düz Alınlı Damlatmasız Manifold

Temperature Range - Temperaturbereich - Sıcaklık Aralığı  
-20°C +100°C (-4°F +212°F) Nitril (N)  
-10°C +180°C (+14°F +356°F) FPM (V)

Max.Working Pressure - Max. Betriebsdruck - Max. Çalışma basıncı  
rtc M115.03 100 bar (1450 PSI)

Flow size - Nennweiten - Akış Çapı  
rtc M115.03 3 mm  
rtc M115.05 5 mm

Connections - Anschlüsse - Bağlantı  
2 / 4 / 6 / 8 / 10 / 12 / 14 / 16

Circuits - Kreislauf - Giriş/Çıkış  
1 ↔ 1 2 ↔ 2 3 ↔ 3 4 ↔ 4 5 ↔ 5 6 ↔ 6 7 ↔ 7 8 ↔ 8



TYPE M115 **rtc**



HYDRAULIC

**rtc** TYPE M301 - Mini-Con



Customised Mini-Connector  
MiniSondermulkupplungen  
Özel Tasarım Mini Manifold

Pneumatic connector is efficient and easy to operate.

Main advantage of the connector is, it can be able to fix up to 16 different pneumatic tubing and takes no effort.

Because of its compact design Mini-Con takes a minimum space.

Mainly using areas; robot control systems, machinery, compressed air.



**PNEUMATIC**

Electrical Connectors

Insulator Types - Isolator Typ - Yalitkan Tipleri

rtc type EC.02	Ø 25.4 mm
rtc type EC.03	Ø 40 mm
rtc type EC.04	Ø 58.5 mm

Temperature Range - Temperaturbereich - Sıcaklık Aralığı

- 30°C +100°C (-22°F +212°F) Nitril (N)
- 40°C +150°C (-40°F +302°F) Silicone (Si)
- 40°C +100°C (-40°F +212°F) Chloroprene (Cp)

Working Current Range (A)	Voltage Range (V)
Ø 1.5    2 - 24 A	25 - 250 V
Ø 2        12 - 24 A	25 - 250 V
Ø 3        34 - 45 A	250 - 440 V
Ø 5        60 - 80 A	250 - 630 V
Ø 6        80 - 110 A	250 - 630 V
Ø 8        150 - 200 A	250 - 630 V
Ø 11      200 - 260 A	250 - 830 V

Electrical Connectors

TYPE EC **rtc**



**ELECTRICAL**

**rtc** TYPE Customised Multi Coupling System

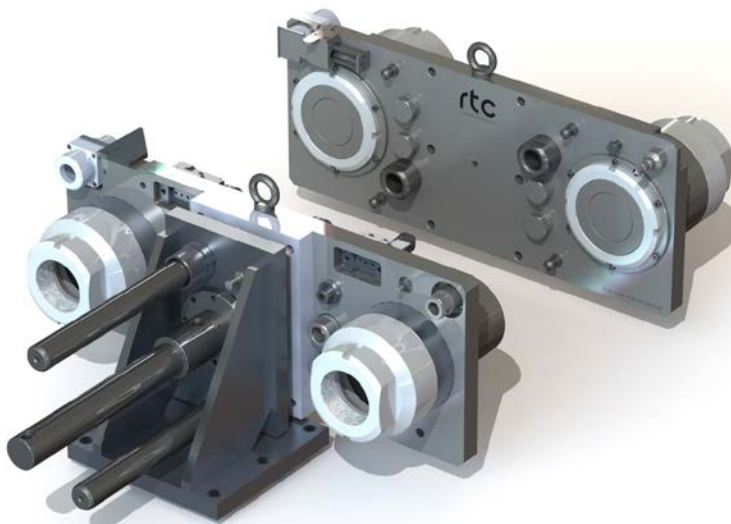

Customised Multi-Couplings  
Sondermulkupplungen nach Kundenwunsch  
Özel Tasarım Manifold

Customised Multi-Couplings are specially designed according to the customer's needs.

All kinds of connections, such as, **Water**, **Pneumatic**, **Hydraulic** and **Electrical Connectors** can be mounted on the same plate, in order to minimise the mold changing time without any possible mistake.

Our Research & Development team provides the best solution to the end users, according to the specific inquiries.

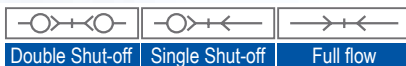

**WATER**  
**PNEUMATIC**  
**HYDRAULIC**  
**ELECTRICAL**

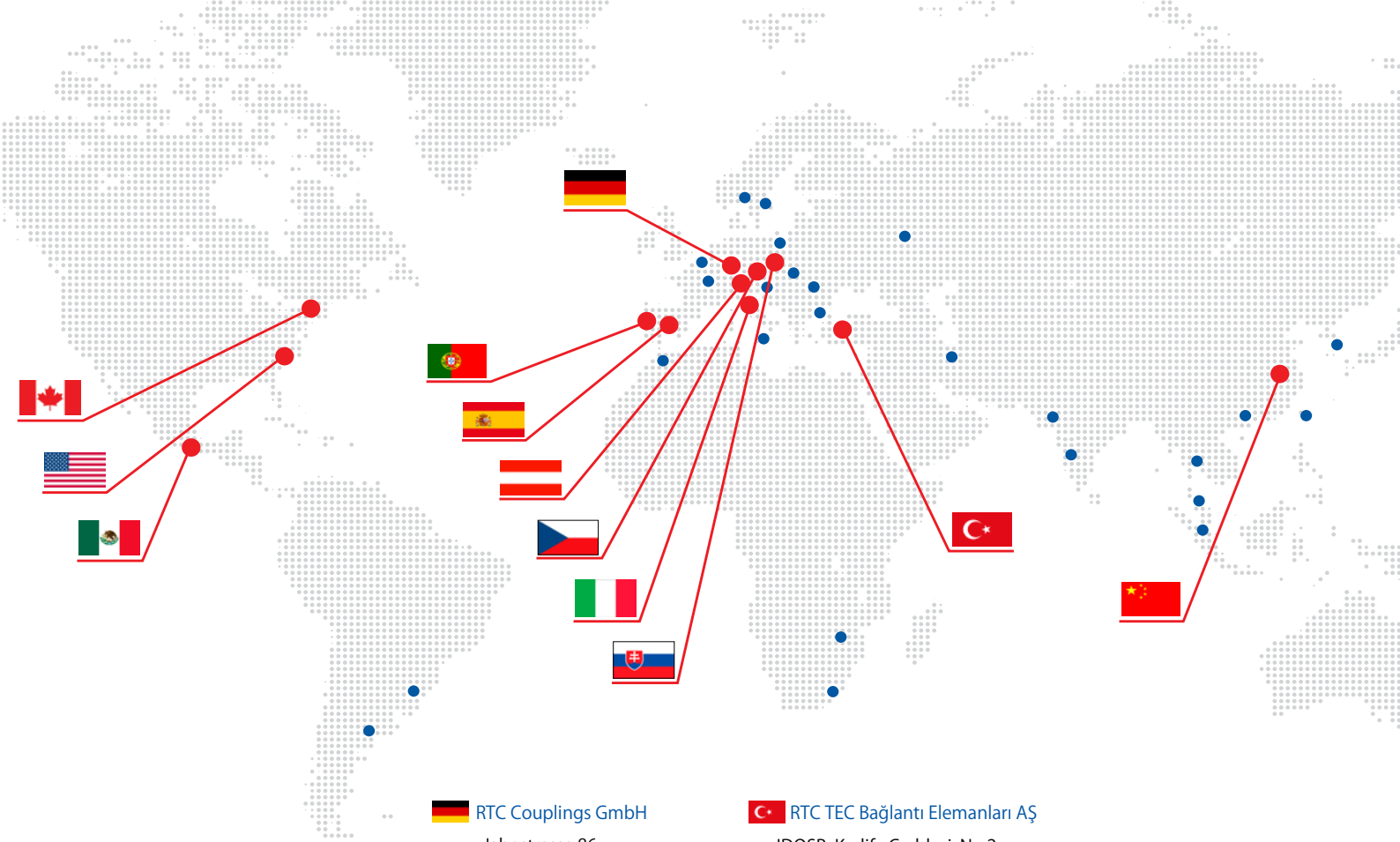

 RTC Couplings GmbH

Jahnstrasse 86  
73037 Göppingen  
GERMANY  
Tel: +49 7161 98796-50  
Fax: +49 7161 98796-79  
mail@rtc-couplings.com

 RTC TEC Bağlantı Elemanları AŞ

IDOSB, Kadife Caddesi, No:2  
PK:34956 Aydınli / Tuzla / İstanbul  
TÜRKİYE  
Tel: +90 216 593 47 82  
Fax: +90 216 593 47 85  
info@rtc-tec.com

 RTC Couplings GmbH

AUSTRIA / Schörfling - Tel: +43 664 4143405 - austria@rtc-couplings.com

 RTC Couplings Northamerica Ltd.

CANADA / London - Tel: +1 519 2048334 - canada@rtc-tec.com

 RTC Couplings Shanghai Co.Ltd.

CHINA / Shanghai - Tel: +86 21 60499692 - china@rtc-tec.com

 RTC Couplings s.r.o

CZECH REPUBLIC / Brno - Tel: +420 608 195882 - czechrepublic@rtc-couplings.com

 RTC Couplings Srl.

ITALY / Vizzolo Predabissi - Tel: +39 02 83476068 - italy@rtc-couplings.com

 RTC Couplings S.de R.L. de C.V.

MEXICO / Queretaro - Tel: +52 1 442 2774801 - mexico@rtc-tec.com

 RTC Couplings Lda.

PORTUGAL / Santiago de Riba - Tel: +351 256 068466 - portugal@rtc-couplings.com

 RTC Couplings Lda.

PORTUGAL / Marinha Grande - Tel: +351 244 560221 - portugal@rtc-couplings.com

 RTC Couplings s.r.o

SLOVAKIA / Bratislava - Tel: +421 911 459352 - slovakia@rtc-couplings.com

 RTC Couplings S.L.

SPAIN / Tortosa - Tel: +34 656 646083 - spain@rtc-couplings.com

 RTC Couplings S.L.

SPAIN / Alicante - Tel: +34 656 646083 - spain@rtc-couplings.com

 RTC Couplings LLC

USA / North Carolina - Tel: +1 519 2048334 - usa@rtc-tec.com

 facebook.com/rtc.couplings

 linkedin.com/company/rtc-couplings

 instagram.com/rtccouplings



[www.rtc-tec.com](http://www.rtc-tec.com)  
[www.rtc-couplings.com](http://www.rtc-couplings.com)

